

# Introducing Fieldstone

Tradesman Style



Shown with optional round cedar rails

**INTRODUCTORY  
PRICE**

**\$142,500**

RETAILS at  
**\$165,750**

**6x8 D Log Complete Package Price**

**\$154,000**

**8x8 D Log Complete Package Price**

**Limited Time Offer No other discounts apply**

Order w/20% Deposit November 30, 2024

Take Delivery by July 31, 2025

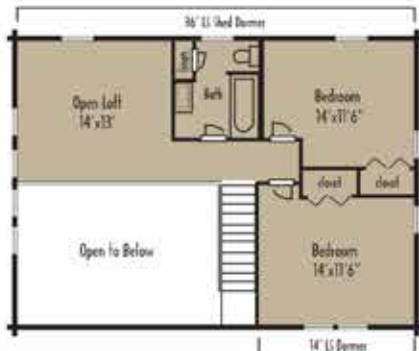

### Complete Package Includes:

Kiln-dried and pre-cut log walls, Andersen® 400 Series TW windows, Therma-Tru® doors, loft system, complete roof system, interior framing with T&G pine to finish, solid wood interior doors, locksets, engineered plans if needed and much more! See complete details at:

[www.coventryloghomes.com](http://www.coventryloghomes.com)

**26x36 • 1,586 sq ft**

**3 bedrooms • 2.5 baths**



**COVENTRY**  
log | timber | hybrid

**COVENTRY LOG HOMES, INC.**

108 South Court Street • Woodsville, New Hampshire 03785  
[www.coventryloghomes.com](http://www.coventryloghomes.com) • [info@coventryloghomes.com](mailto:info@coventryloghomes.com)

Call Our Log Home Experts  
**1-800-308-7505**



# Fieldstone Model

## Package Contents

### ***Includes:***

All the log siding skirtboard  
All the precut log porch headers  
All the porch posts 6"x6"  
All the porch beam rafters 4"x8"  
All the precut log walls  
All the precut log gables  
All the logs are numbered  
All the logs are Eastern White Pine  
All the logs are kiln-dried  
All the log home caulking  
All the log home foam gasket  
All the precut log home splines  
All the 11" Log Hog fasteners  
All the log siding for dormer  
All the T&G pine for dormer interior walls  
Detailed construction manual  
Three sets of construction plans  
Unlimited technical service  
All the porch ceiling T&G pine  
All the roof rafters 2"x12" 16" O.C.  
All the roof sheathing 5/8" OSB  
All the membrane sheathing for roof  
All the soffit material T&G pine  
All the fascia material 1"x8" pine  
All the exterior pine 1x4 window & door trim  
All the architectural shingles needed

# Tradesman Style

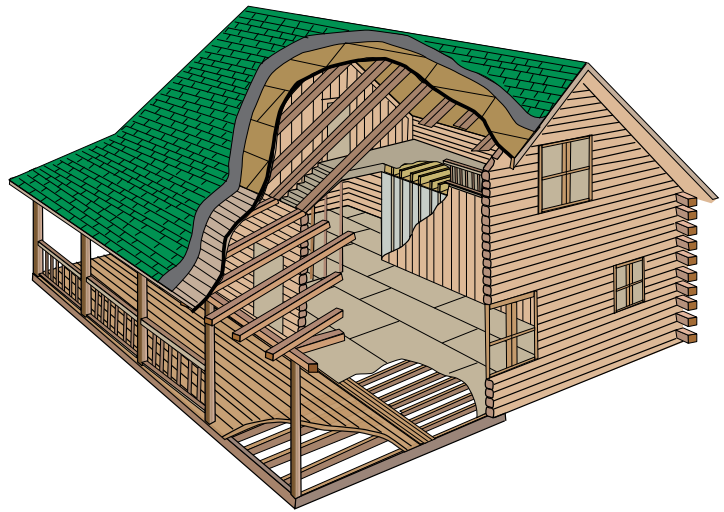

All the Andersen 400 Series tilt-wash low-E insulated windows complete with full screens  
6 foot Andersen Frenchwood sliding door  
All the exterior doors 3/0x6/8 Therma-Tru Fiberglass insulated 9 lite with adjustable sills  
All the Schlage locksets  
All the window & door jambs & exterior trim pine  
All the sills for the floor system PT  
All the girder materials 2"x10"  
All the perimeter box 2"x10"  
All the floor joists 2"x10 16" O.C.  
All the subfloor 3/4" Advantech for first floor & loft  
All the loft and basement stairs  
All the porch joists & flooring PT  
All the porch railings PT  
All the interior framing kiln-dried  
All the T&G pine for wall paneling  
All the T&G pine for ceiling  
All the pre-hung interior doors solid 6 panel pine with hardware